

MIDLAND METRO
 (WEDNESBURY TO BRIERLEY HILL AND MISCELLANEOUS AMENDMENTS) ORDER

SANDWELL METROPOLITAN BOROUGH

APPLICATION FOR PLANNING DIRECTION

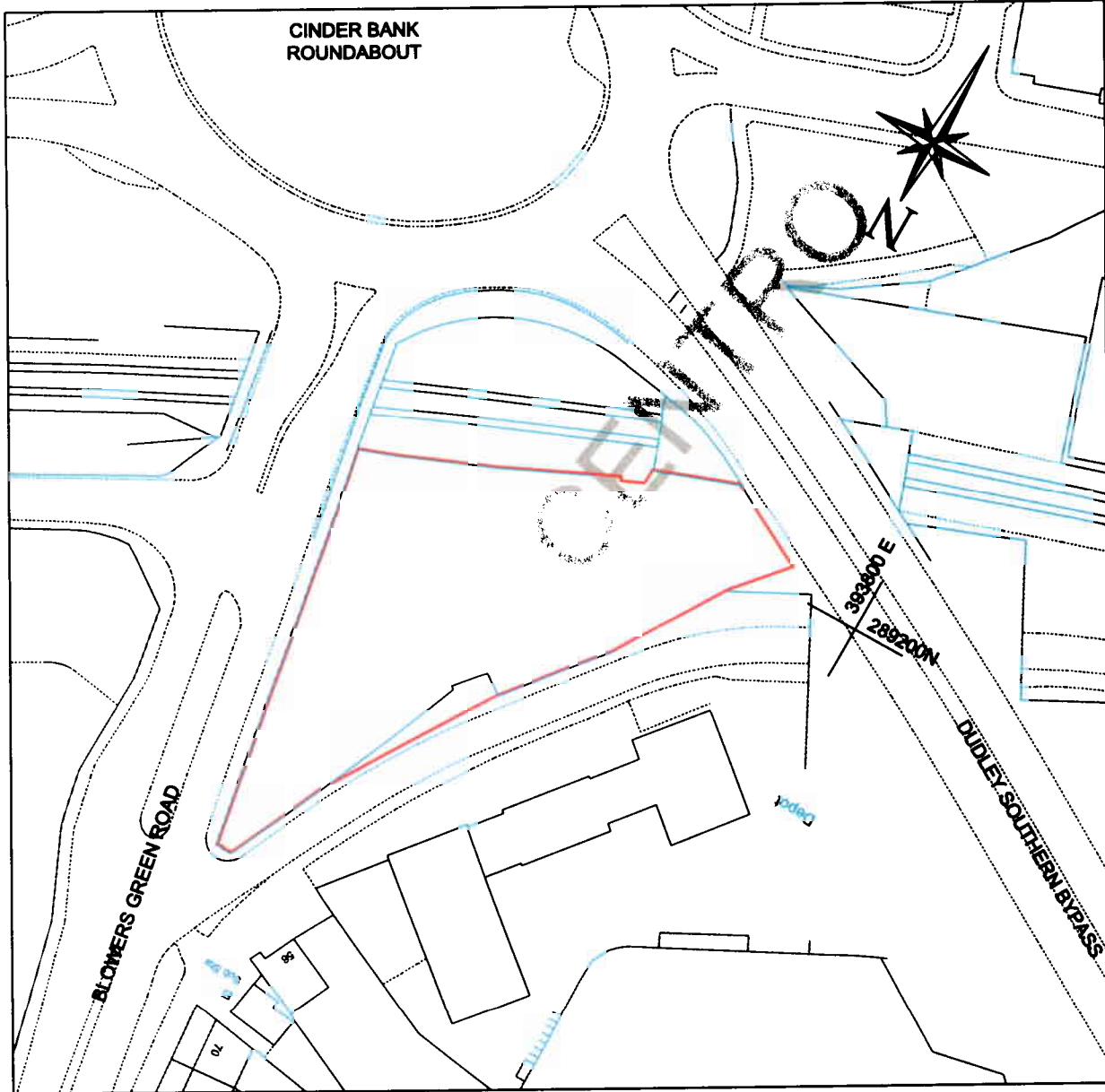

Proposed Park and Ride Site - Cinder Bank

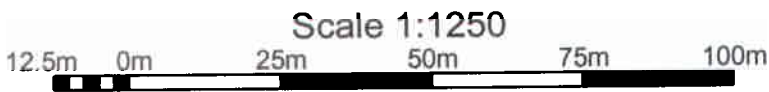

Reproduced from the Ordnance Survey map
 Issue with the permission of the controller of the
 Mapping's Stationary Office. Crown Copyright
 Licence No. LA 08914L.
 Unauthorised reproduction infringes Crown
 Copyright and may lead to prosecution or Civil
 Proceedings.

Title Midland Metro (Wednesbury to Brierley Hill) Proposed Park and Ride Site Cinder Bank				1 ALLOTT & LOMAX Fairbairn House, Ashton Lane, Sale, Manchester, M33 6WP Tel: (0161) 962 1214 Fax: (0161) 905 5855			
Date	Drawn	Checked	Approved	Scale	Drawing No.	Rev	Status
8/4/03	P.W.			1:1250	22216 / 502 / 20		