

MIDLAND METRO
(WEDNESBURY TO BRIERLEY HILL AND MISCELLANEOUS AMENDMENTS) ORDER

SANDWELL AND DUDLEY METROPOLITAN BOROUGHS

APPLICATION FOR PLANNING DIRECTION

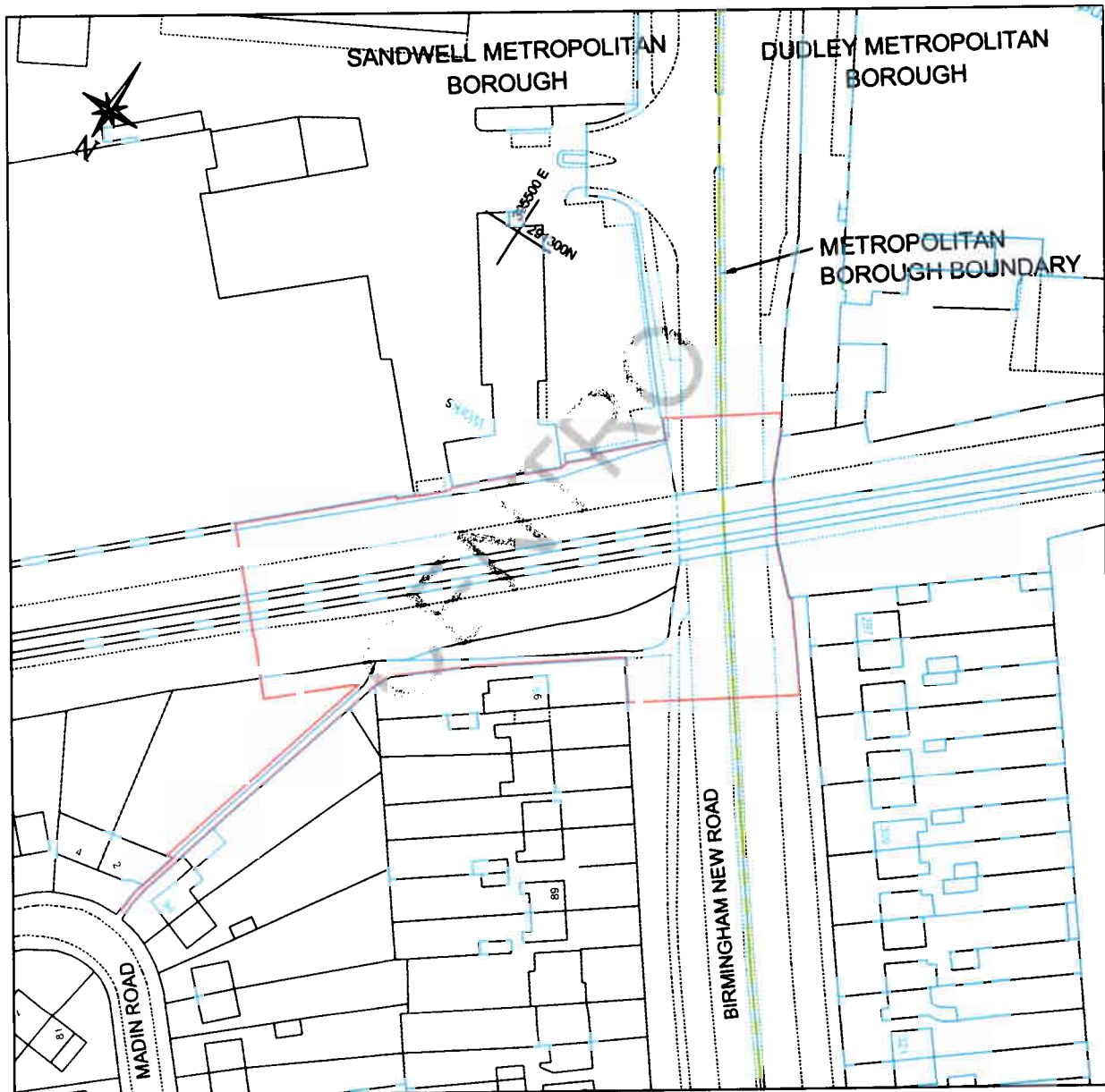

Proposed Stop Location - Birmingham New Road



Reproduced from the Ordnance Survey map base with the permission of the controller of Her Majesty's Stationary Office. Crown Copyright
© Crown Copyright
Unauthorised reproduction infringes Crown Copyright and may lead to prosecution or Civil Proceedings

Title
Midland Metro
(Wednesbury to Brierley Hill)
Proposed Stop Location
Birmingham New Road

1 ALLOTT & LOMAX

Fairbairn House,
Ashton Lane, Sale,
Manchester, M33 6WP

Tel: (0161) 962 1214
Fax: (0161) 905 5855

Date	Drawn	Checked	Approved	Scale	Drawing No.	Rev	Status
3/4/03	C.H			1:1250	22216 / 502 / 06		