

MIDLAND METRO  
 (WEDNESBURY TO BRIERLEY HILL AND MISCELLANEOUS AMENDMENTS) ORDER

SANDWELL METROPOLITAN BOROUGH  
 APPLICATION FOR PLANNING DIRECTION

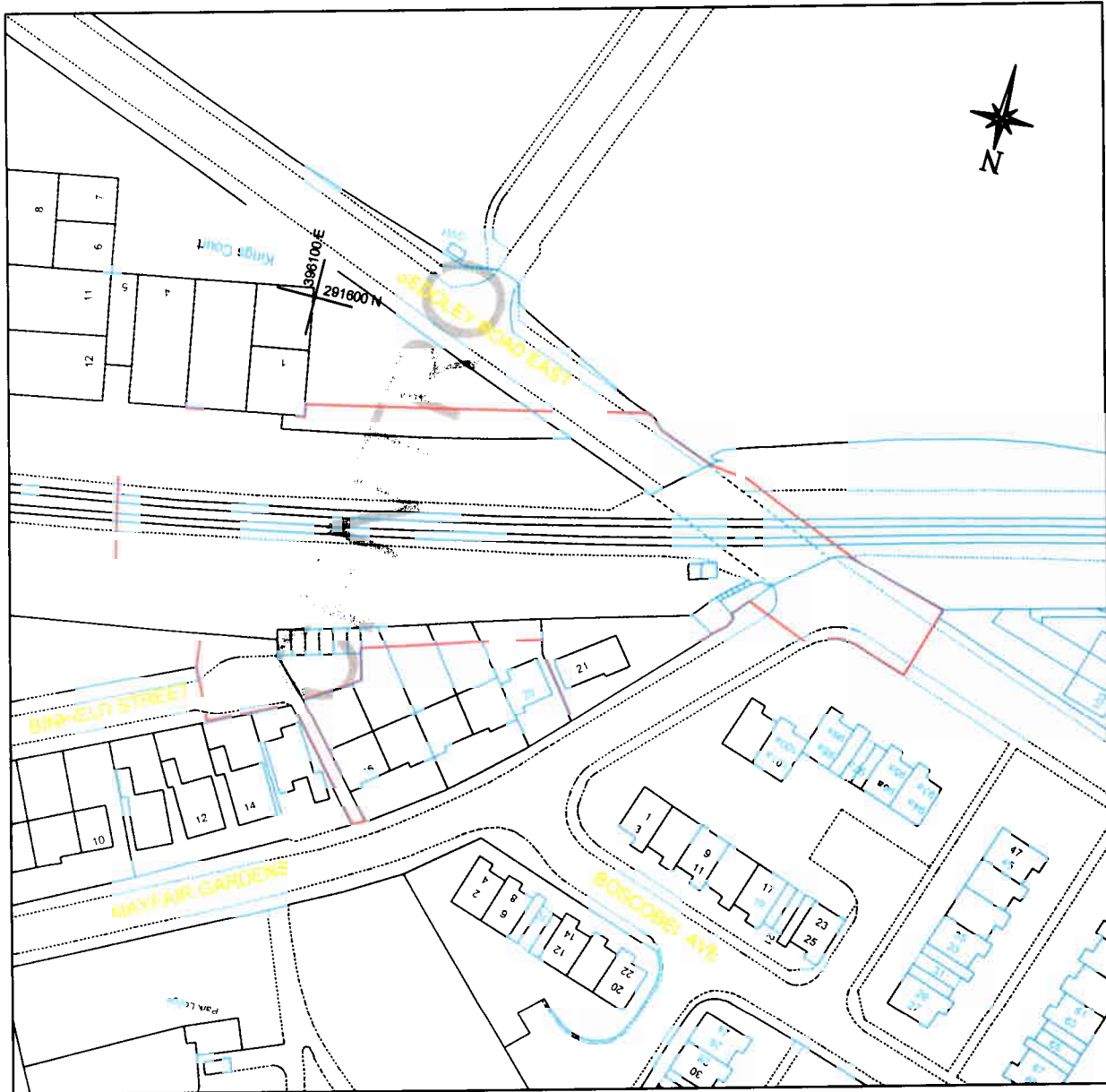

**Proposed Stop Location - Sedgley Road East**

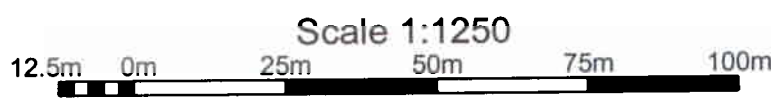

Reproduced from the Ordnance Survey map base with the permission of the Controller of Her Majesty's Stationery Office. Crown Copyright  
 Licence No. JH 100714  
 Unauthorized reproduction infringes Crown Copyright and may lead to prosecution or Civil Proceedings.

Title Midland Metro (Wednesbury to Brierley Hill) Proposed Stop Location Sedgley Road East				<p style="font-size: 2em; font-weight: bold; margin: 0;">1</p> <h1 style="margin: 0;">ALLOTT &amp; LOMAX</h1> Fairbairn House, Ashton Lane, Sale, Manchester, M33 6WP Tel: (0161) 962 1214 Fax: (0161) 905 5855			
Date	Drawn	Checked	Approved	Scale	Drawing No.	Rev	Status
3/4/03	C.H			1:1250	22216 / 502 / 05		