

MIDLAND METRO
(WEDNESBURY TO BRIERLEY HILL AND MISCELLANEOUS AMENDMENTS) ORDER

SANDWELL METROPOLITAN BOROUGH

APPLICATION FOR PLANNING DIRECTION

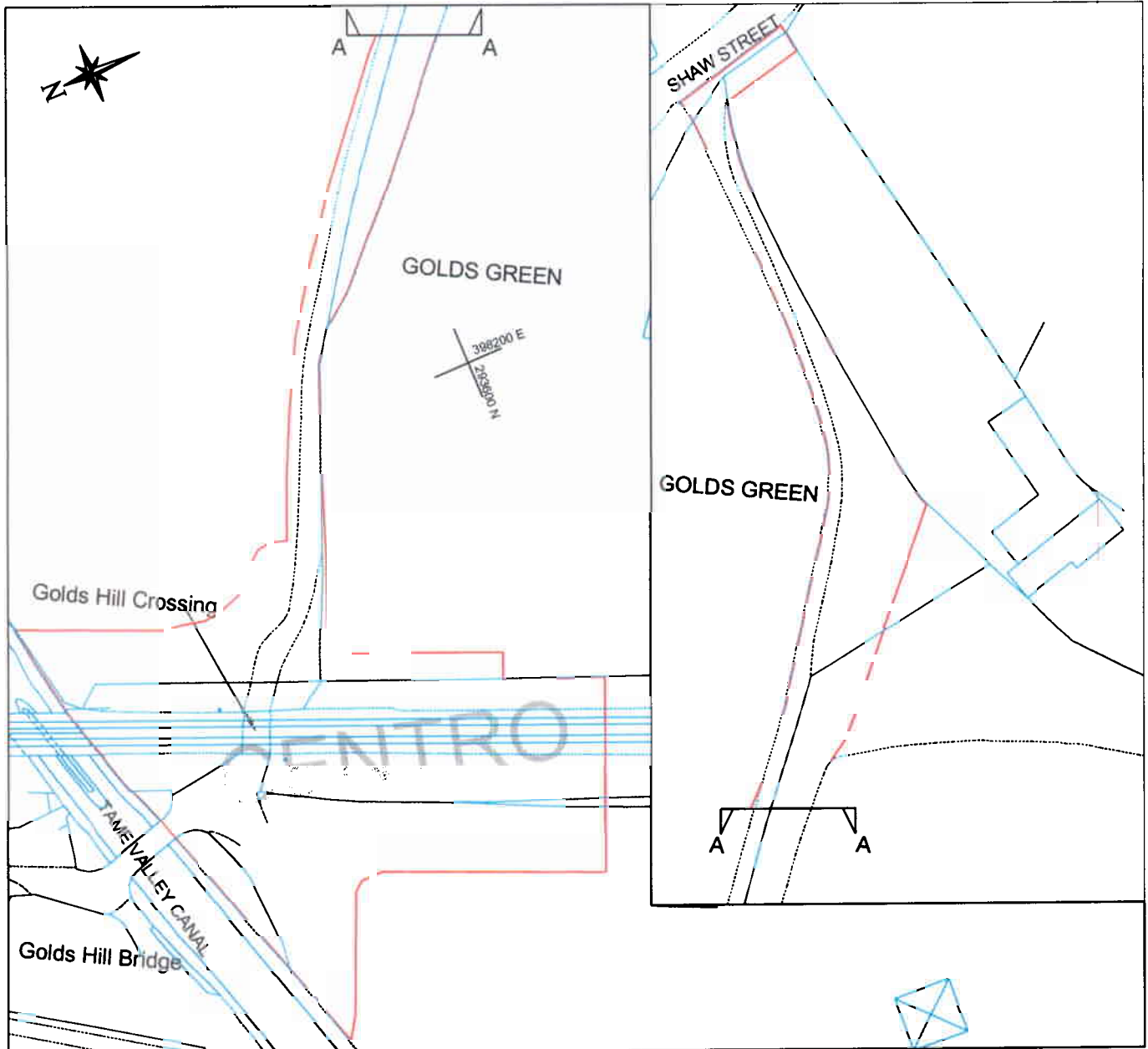

Proposed Stop Location - Golds Hill Crossing



Reproduced from the Ordnance Survey map base with the permission of the controller of the Ministry's Stationery Office. Crown Copyright
 Licence No. LA 05914L
 Unauthorised reproduction infringes Crown Copyright and may lead to prosecution or Civil Proceedings

Title
 Midland Metro
 (Wednesbury to Brierley Hill)
 Proposed Stop Location
 Golds Hill Crossing

1 ALLOTT & LOMAX

Fairbairn House,
 Ashton Lane, Sale,
 Manchester, M33 6WP

Tel: (0161) 962 1214
 Fax: (0161) 905 5855

Date	Drawn	Checked	Approved	Scale	Drawing No.	Rev	Status
3/4/03	C.H			1:1250	22216 / 502 / 01		