

WORKS PLANS AND SECTIONS

SHEET No. 20

DEPARTMENT OF TRANSPORT

MIDLAND METRO
(WEDNESBURY TO BRIERLEY HILL AND MISCELLANEOUS AMENDMENTS)
ORDER

SANDWELL AND DUDLEY METROPOLITAN BOROUGHS

SECTIONS FOR WORKS Nos. 2D, 3A, 3B, 3C, 9A, 9B, 9C and 11A

For bridges to be widened or reconstructed, the existing structures are shown hatched

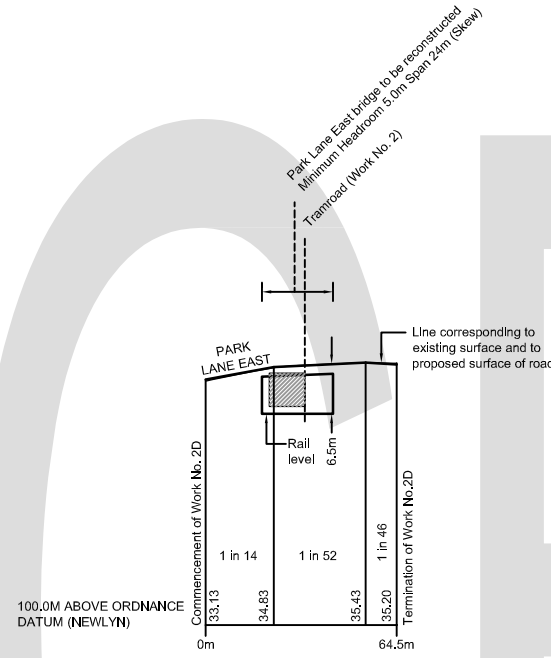

WORK No. 2D
Park Lane East bridge reconstruction and widening

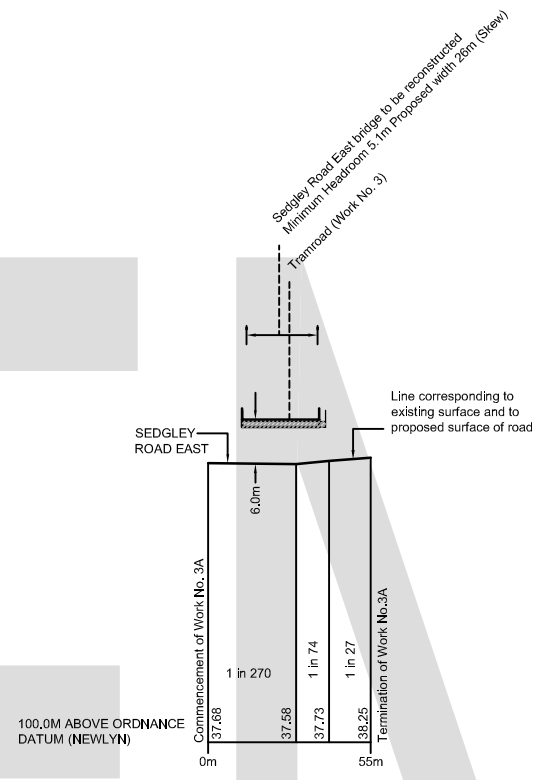

WORK No. 3A
Sedgley Road East bridge reconstruction and widening

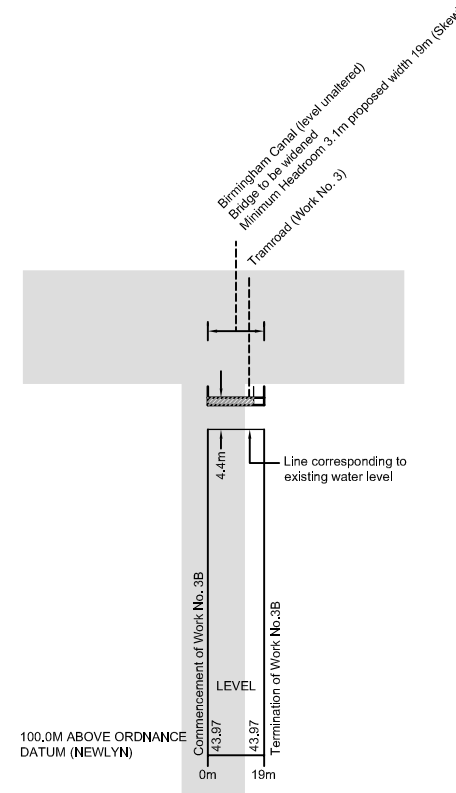

WORK No. 3B
Birmingham Canal bridge widening

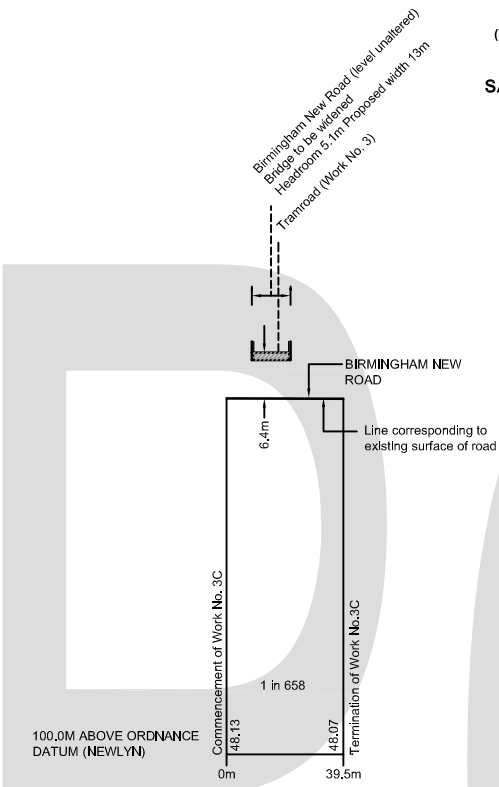

WORK No. 3C
Birmingham New Road bridge widening

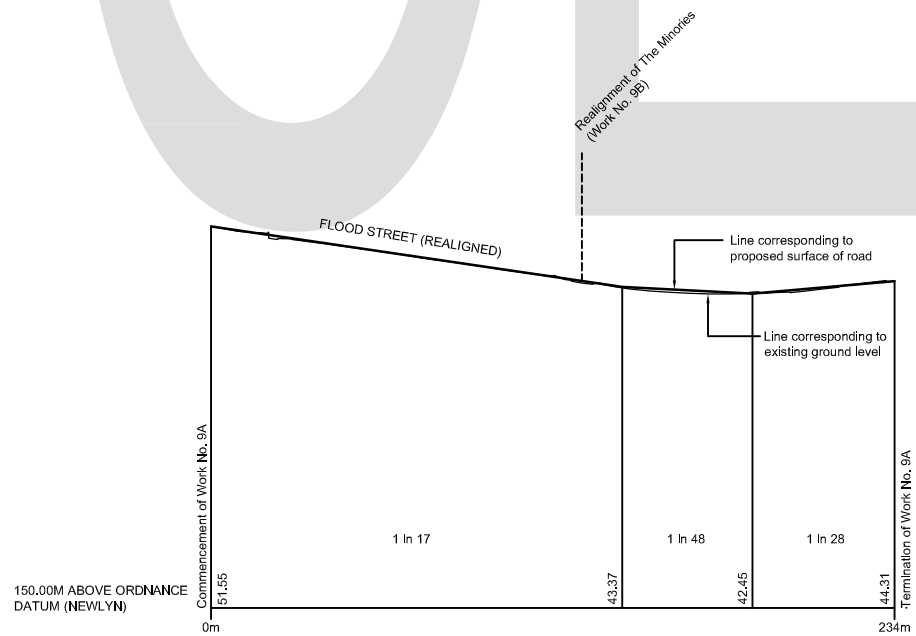

WORK No. 9A
Flood Street realignment

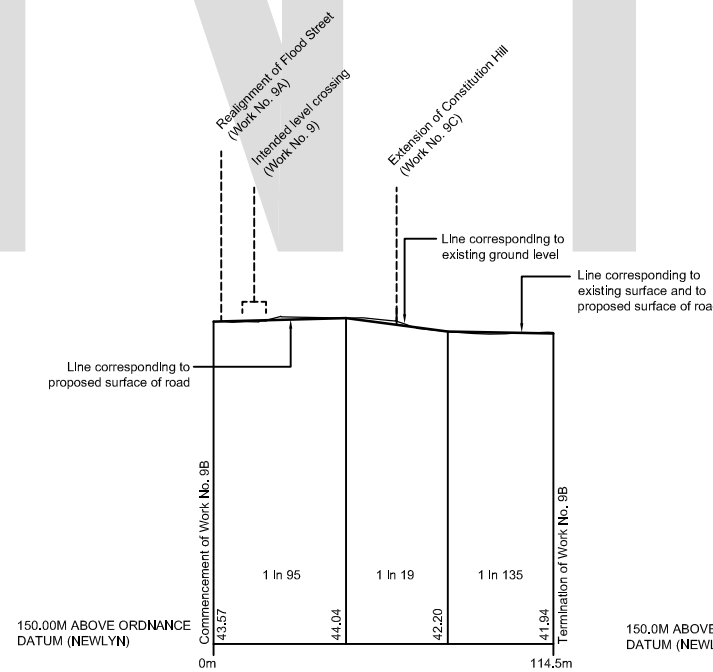

WORK No. 9B
The Minories realignment

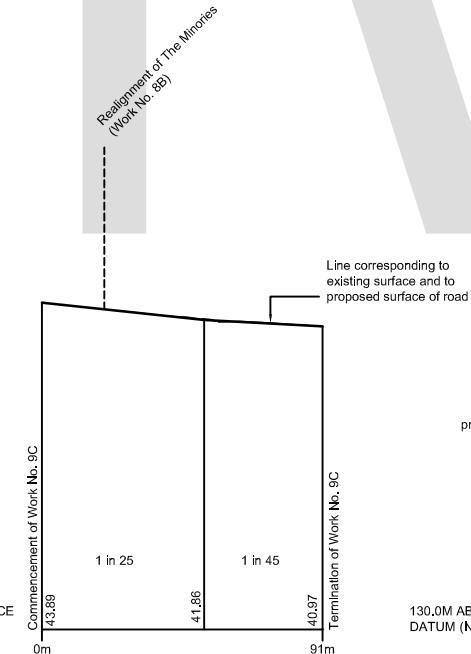

WORK No. 9C
Constitution Hill extension

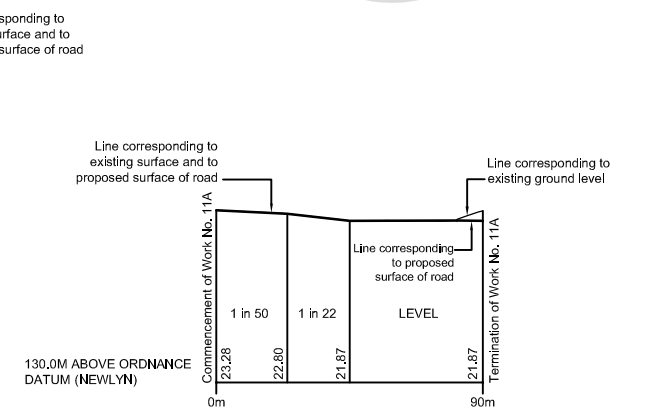

WORK No. 11A
Pedmore Road tramstop access road from Buxton Road

